

There is also the facility of a variable speed control, located on the right hand side of the machine. Lower speeds should be used when finishing off or sanding fine materials, higher speeds for rough or heavy sanding.

To switch ON.
The Belt Sander is fitted with a standard ON/OFF trigger, simply squeeze the trigger to activate the sander.

If using an Wheeled Sander.
With the machine switched OFF and isolated from the power supply, lay the sander on its side.

The abrasive brush or flapper wheel (dependent on application) is **already fitted to the machine**. If you require the abrasive to be changed contact your 'local HSS Hire Shop.

The sander has a built in dust extraction port. **To use the dust extraction facility, slide the cover to the open position and connect a suitable vacuum hose directly to the machine.**

If dust extraction is not to be used, the cover must be in the closed position.

To adjust the contact height of the abrasive, simply raise or lower the front jockey wheel.

To switch on.
The Wheeled Sander is fitted with a standard ON/OFF trigger, simply squeeze the trigger to activate the sander.

BASIC TECHNIQUE

Always hold the sander with both hands and switch ON before bringing the sander into contact with the work.

Never apply too much pressure. Keep the sander moving either in a straight line or in a circular motion, or it may rut the work.

Lift it clear before switching OFF, and wait for moving parts to stop before putting it aside.

On first contact with the surface, the sander will try to throw you off line. Practice on a piece of scrap material before attempting the main work.

EQUIPMENT CARE

Never push the equipment beyond its design limits. If it will not do what you want with reasonable ease, assume you have the wrong tool for the job. Ask at your local HSS Hire Shop for advice.

Always switch OFF and unplug the sander before making any adjustments to it.

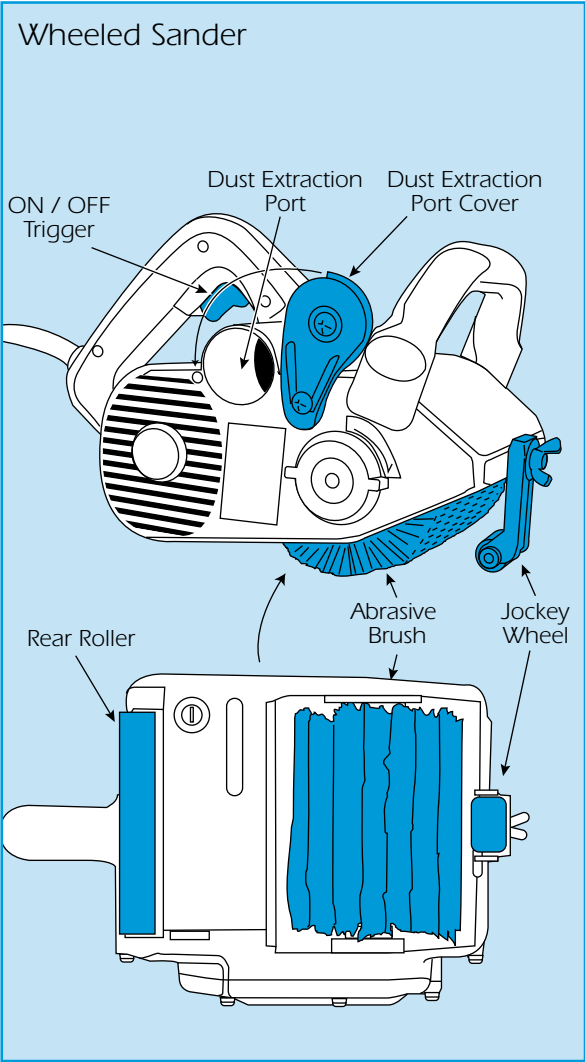

Always use the correct abrasive for the job and (where applicable) change it as soon as it becomes clogged or damaged. **Never use the sander without an abrasive fitted.**

Empty dust bags when about a third full, and before leaving the sander for any length of time. **Dispose of wood dust carefully** (see warning box).

Keep the equipment clean. You will find this less of a chore if you clean up regularly, rather than wait until the end of the hire period.

When not in use, **store the equipment somewhere clean, dry and safe** from thieves.

FINISHING OFF

Switch OFF and unplug the sander.
Remove any fitted abrasive (do not remove the abrasive fitted to the Wheel Sander), **empty the dust bag and clean the sander.**
Neatly coil its flex ready for return to your local HSS Hire Shop.



©HSS Hire Service Group Plc 1996 No. 514/01
Group Office: 25 Willow Lane, Mitcham, Surrey CR4 4TS

Operating & Safety Guide 514

HSS Hire Shops



Sanders:
Belt, Wheeled

For quick heavy sanding and the removal of textured coatings

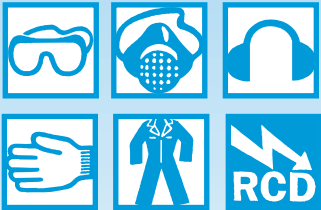

GENERAL SAFETY

For advice on the safety and suitability of this equipment contact your local HSS Hire Shop.

Keep children, animals and bystanders away from the work area.

Never use this equipment if you are ill, feeling tired, or under the influence of alcohol or drugs.

This equipment should only be used by a competent person who has read and understood these instructions.

Ensure the work area is well ventilated and free from anything that could ignite wood dust- this can be explosive. Do not sand near flammable gasses or liquids.



Safety Goggles MUST be worn by everyone in the work area.



NOTE: Some materials (textured surfaces for example) contain substances which, when sanded, can be harmful to health. A suitable mask must be worn when using this equipment.



NOTE: This equipment generates potentially harmful noise levels. To comply with health and safety at work regulations, ear defenders must be worn by everyone in the vicinity.



Wear practical, protective clothing, gloves and footwear. Avoid loose garments and jewellery that could catch in moving parts.

Fire Hazard

Wood dust can be dangerous.

Never tip it into a fire or incinerator- it may explode.

Never leave it packed in a dust-bag or similar container – it can ignite spontaneously.

To dispose of it safely, mix it with general rubbish.

Check the equipment before use. If it shows signs of damage or excessive wear, return it.

Think twice before locking the ON/OFF control in the ON position using any trigger lock.

If working above ground-level, work from a suitable, stable platform - an access tower for example. Never work from ladders or steps.

Information on COSHH regulations is available from your local HSS Hire Shop.

ELECTRICAL SAFETY

Most HSS power tools plug into a standard 13amp power socket. However, 110v tools (with a round yellow plug) must be provided with a suitable 110v generated supply, or powered from the mains via a suitable 110v transformer.

Keep the flex out of harm's way, draping it over one shoulder to keep it clear of moving parts.

Extension leads should be fully unwound and loosely coiled, away from the equipment. Never run them through water, over sharp edges or where they could trip someone.

Using electrical equipment in very damp or wet conditions can be dangerous.



To reduce the risk of electric shock, use a suitable RCD (Residual Current-Operated Device) available from your local HSS Hire Shop, or power 240V (Not 110V) equipment from a power circuit with a built-in RCD.

Siting an RCD

When used with a transformer an RCD will only protect the user if fitted between the transformer and the tool being used.

An RCD fitted between the power supply and the transformer only protects up to the transformer.

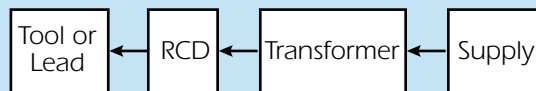

If the equipment fails, or if its plug or lead gets damaged, return it. Never attempt to repair it yourself.

Never carry or pull the equipment by its flex.

Ensure the machine and power socket are switched OFF before plugging into the power supply and when making any adjustments.

GETTING STARTED

Ensure the work is free from nails, screws etc. If these cannot be removed, drive them well below the surface.

Fit the sander with the appropriate abrasive. In general, start with a medium grade, then work through to a fine grade until the desired finish is achieved.

Belt Sander

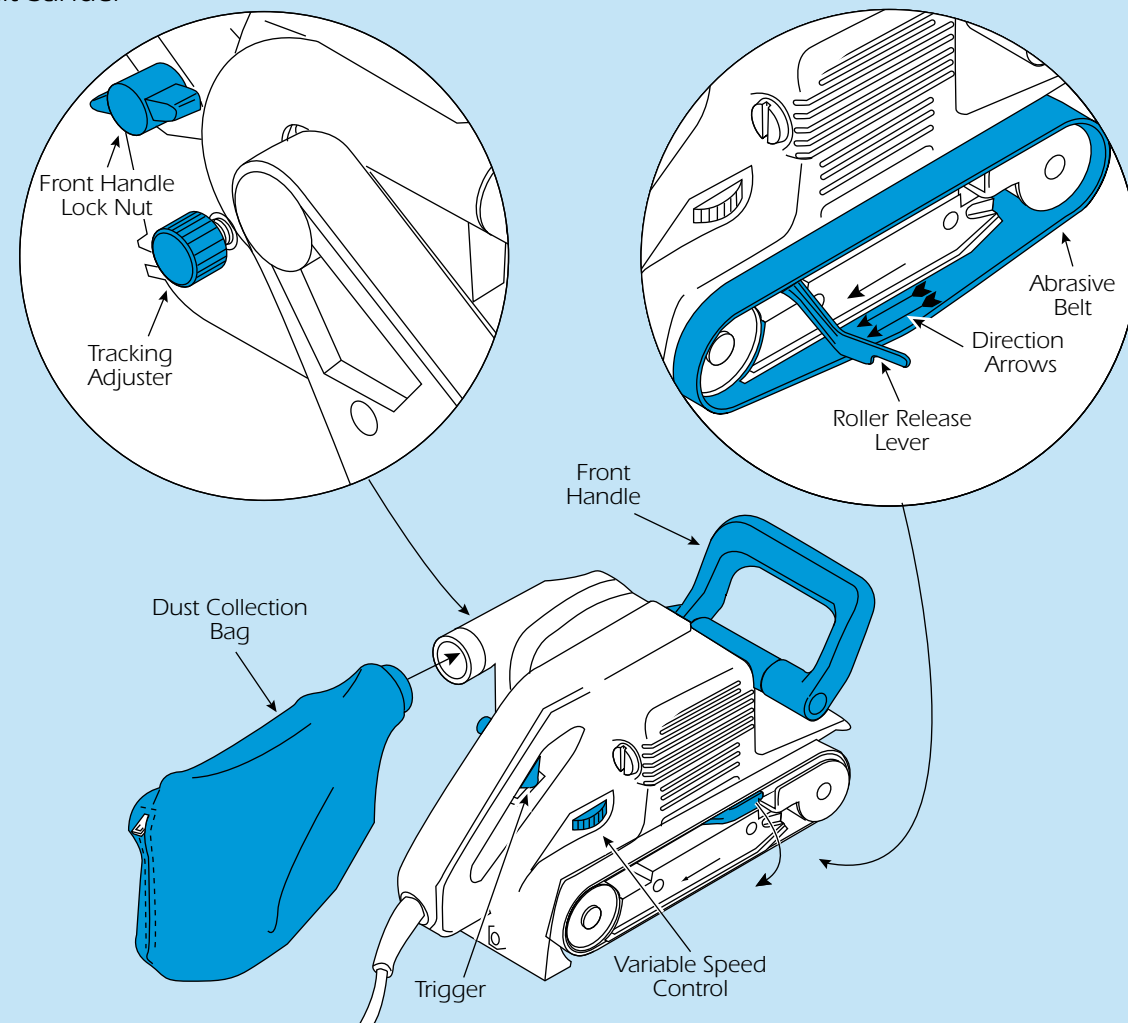

If using a Belt Sander.

With the machine switched OFF and isolated from the power supply, turn the sander on its back and place on a secure work surface.

Release the front roller by pulling the release lever back, then slide on the belt. Make sure the arrows printed on the inside of the belt point in the same direction as the arrows on the sander (see diagram).

Position the belt so that it sits centrally over the rollers then return the release lever to its original position.

Set the variable speed control to the slowest setting (1).

Check that the machine is clear of cables, tools and

materials. Plug the sander into an appropriate power supply and switch the power on.

Taking great care, start the sander using your left hand, by squeezing the trigger. With the sander running adjust the tracking of the belt, by turning the tracking adjuster with your right hand, either clockwise or anti clockwise until the belt runs centrally to the rollers. This operation may be required on several occasions, as the belt may wander during the sanding process.

The sander has a built in dust extraction system, which places the dust into a removable collection bag. To empty, open the zip on the rear of the bag and tip the contents into a suitable container.