

During use, the alarm LEDs will flash and a single tone alarm will sound if the battery power drops to a low level. If this happens, evacuate the area of all personnel and arrange re-charging (see 'ELECTRICAL SAFETY').

To switch the gas detector OFF press both the ON button and the blank button (see illustration) at the same time.

BASIC TECHNIQUES

If one of the three gasses is detected in the atmosphere or the level of Oxygen drops, the red alarm LEDs will flash in quick succession and the audible alarm emits a fast warbling noise at approximately 104dB.

The back light will come on and the word 'ALARM' will flash on the display next to the gas in question.

If the alarm sounds, evacuate all personnel from the contaminated area.

LINKING TWO OR MORE UNITS

The Area Multi-Gas Detector can be linked to one or more additional units.

The advantage of this is, if one unit goes into alarm, all the other units linked to it will also go into alarm to give warning over a greater area.

To link the units together, ensure all the units are fully charged (see 'ELECTRICAL SAFETY') and switched OFF.

Unscrew the cover on one (or both if connecting more than two units) of the interconnection sockets and connect a link lead to it. Connect the other end of the link lead to the interconnection socket on the second unit.

Where more than two units are to be connected, simply continue linking from one to the next.

You can now switch each unit ON and wait until all have carried out their self-test sequence.

When one unit goes into an alarm situation its LEDs will flash and the audible alarm will sound as normal.

The other units will sound an audible alarm but their LEDs will flash at a slower rate enabling the operator to locate the alarm area.

If the alarm sounds, evacuate all personnel from the contaminated area.

EQUIPMENT CARE

Never push the equipment beyond its design limits. If it is unsuitable for the task you are performing DO NOT USE OR RELY ON IT. Contact your local HSS Safe and Sure Depot for advice.

Handle the equipment with care. Avoid dropping it, knocking it, or otherwise exposing it to damage.

Never expose the equipment to excessive moisture, dust or dangerous/corrosive chemicals.

Keep the equipment clean. You will find this less of a chore if you clean up regularly rather than wait until the end of the hire period.

When not in use, remember to switch OFF, then store the unit somewhere clean, dry and safe from thieves.

FINISHING OFF

Switch the unit/s OFF and where applicable, disconnect the link lead/s.

Finally, neatly coil the charger lead and place all parts together ready for return, to your local HSS Safe and Sure Depot.

Cleaning

The operator has a duty of care to ensure the equipment is returned clean of any potentially harmful contaminants or body fluids.

Equipment that has not been cleaned will not be accepted back by HSS.



...any comments?

If you have any suggestions to enable us to improve the information within this guide please fax your comments or write to the Product Manager at the address below

Fax: 020 8687 5001

©HSS Hire Service Group Plc 2001 No. SS042/01
Group Office: 25 Willow Lane, Mitcham, Surrey CR4 4TS

Web Site: <http://www.hss.co.uk/safeandsure>

Operating & Safety Guide SS042

SS042/01

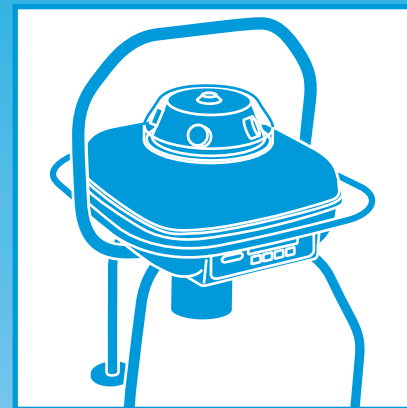

Area Multi-Gas Detector

A gas detector designed to detect the presence of Methane, Hydrogen Sulphide and Carbon Monoxide and Oxygen.



Code 34074

GENERAL SAFETY

For advice on the safety and suitability of this equipment contact your local HSS Safe and Sure Depot.

There is a serious risk of personal injury if you do not follow all instructions laid down in this guide.

The hirer has a responsibility to ensure that all necessary risk assessments have been completed prior to the use of this equipment.

This equipment should only be used by an operator who has been deemed competent to do so by his/her employer.

This equipment may be used in a workplace subject to a permit to work, it is the hirers responsibility to ensure that the equipment's technical specification meets the requirements of any such permit to work prior to starting work. For further technical information contact your local HSS Safe and Sure Depot.

This equipment should be used by an able bodied, competent adult who has read and understood these instructions. Anyone with either a temporary or permanent disability, should seek expert advice before using it.

Keep children, animals and bystanders away from the work area. Cordon off a NO GO area using cones and either barriers or tape, available for hire from your local HSS Safe and Sure Depot.



Never use this equipment if you are ill, feeling tired, or under the influence of alcohol or drugs.

Wear sensible, suitably protective clothing and footwear plus any safety wear appropriate to the work in progress.

Make sure you know how to operate this equipment safely and are aware of its limitations before you use it.

Remember that this equipment does not guarantee life protection but if used correctly it will help provide a safer environment to work in.

Make sure that anyone in the immediate work area is warned of what you are doing.

Check the condition of the equipment before use. If it shows signs of damage or excessive wear, return it to your local HSS Safe and Sure Depot.

ELECTRICAL SAFETY

The area multi gas detector is powered from a built in battery, which is capable of running the unit for up to 24 hours.

The gas detector battery must only be re-charged in a NON HAZARDOUS ENVIRONMENT.

To recharge the battery, remove the unit to a NON HAZARDOUS AREA.

Unscrew the charge socket protective cover then plug the charge lead into the charge socket (see illustration). The built in charger is designed to plug straight into a standard 230V 13A earthed power socket.

Switch the supply ON and observe the two charge indicator lamps.

The red lamp indicates a fast (full) charge whereas the green lamp indicates a trickle charge. The unit is ready to use when a trickle charge is indicated. Recharging will take between six and eight hours.

Once charged, switch the supply OFF and disconnect the charge lead from the supply and the unit.

Ensure that the charge socket screw on protective cover is replaced.

Using electrical equipment in very damp or wet conditions can be dangerous.



To reduce the risk of electric shock, always use a suitable RCD (Residual Current-Operated Device) available from your local HSS Safe and Sure Depot.

If an extension lead is used for the charger lead it should be fully unwound and loosely coiled, away from the equipment. Never run leads through water, over sharp edges or where they could trip someone.

GETTING STARTED

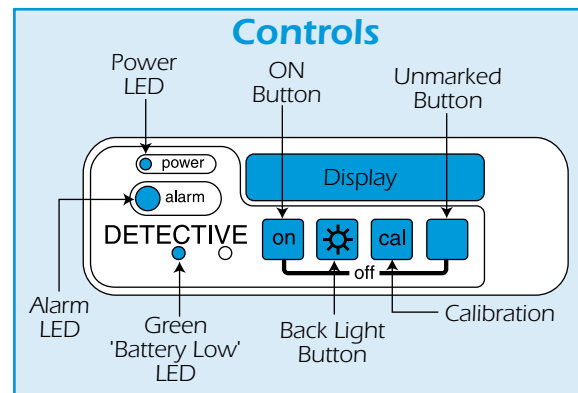

Switch the unit ON by pressing the ON button. The alarm will sound and the red 'alarm' LED will flash for approximately 5 seconds.

The unit will then perform a self-test and will display the current battery condition. The battery voltage must read above 6.4V, if it reads lower, recharge the unit (see 'ELECTRICAL SAFETY').

Area Multi-Gas Detector

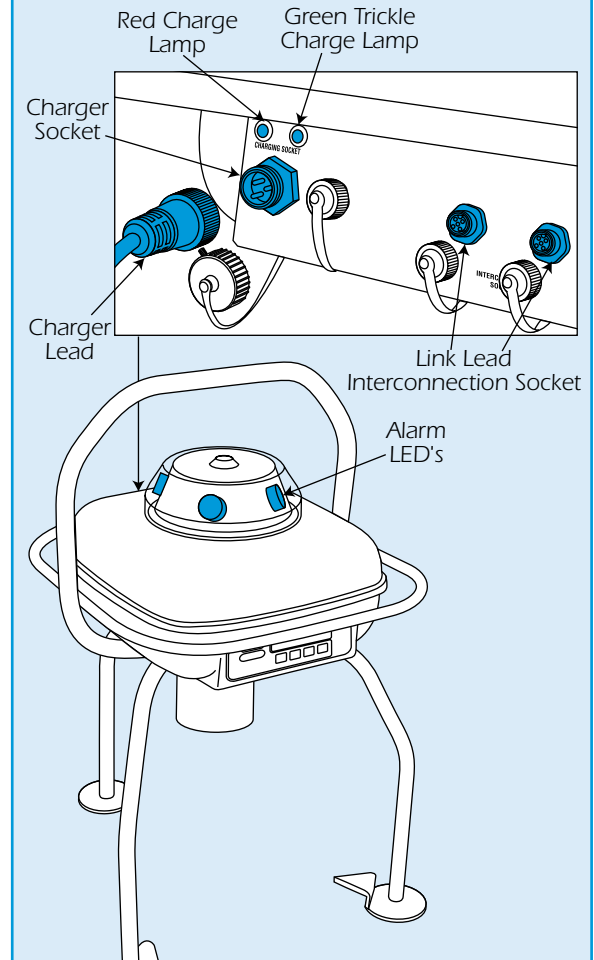

During the self-test, if the unit has passed its due date for re-calibration, 'Calibration due' will show on the display, the red LED will flash and the alarm will sound.

If the words 'Sensors Changed' appear on the display, one or more of the sensor modules may have a fault.

If either warnings occur, DO NOT USE OR RELY ON IT, contact your local HSS Safe and Sure Depot for a replacement unit.

There is a back light facility, which will illuminate the display in poor lighting conditions. To operate the back light press the 'back light' (sun emblem) button, press again to turn the light OFF.

The back light feature comes ON automatically in the event of an alarm.